



WWW.BARRYIND.COM

T50R0-30-28X



BeO

FLANGED TERMINATION

Features:

- ◆ BeO Material
- ◆ DC - 4 GHz Performance
- ◆ 30 Watt Input Power
- ◆ Flange Mount

General Description:

The T50R0-30-28X is a flanged 50 ohm BeO termination. It has an input power of 30 watts, while maintaining a constant flange temperature of 100°C. It offers a frequency range from DC to 4 GHz.

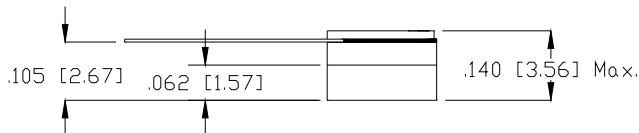
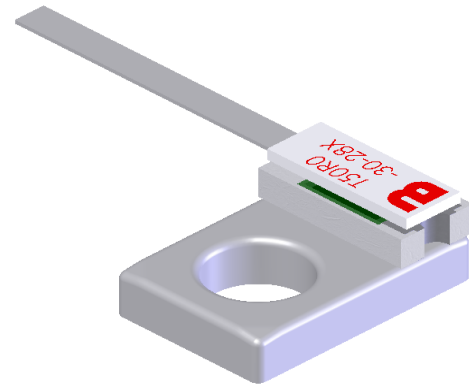
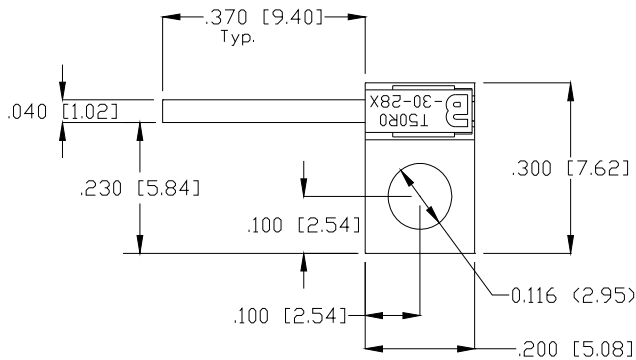

Dimensions in inches [mm]
Tolerance $\pm .010$ [.254]
unless otherwise stated

DERATING CURVE:

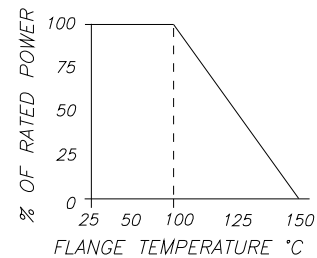

| Parameter | Min. | Typ. | Max. | Units |
|---|----------|------|-----------------------|-------|
| Frequency Range | DC | | 4 | GHz |
| Input Return Loss (DC -2 GHz) (2- 4 GHz) | 18 14 | | | dB |
| Input Power | | | 30 | Watts |
| Resistance | 47.5 | 50.0 | 52.5 | Ohms |
| Flange Temperature | | | 100 150 (0% Power) | °C |

Barry Industries reserves the right to change part number and or process without notification.

Barry Industries, Inc., 60 Walton St., Attleboro, MA 02703 T: 508-226-3350 F: 508-226-3317 E-mail: sales@barryind.com

Barry Industries maintains an ISO 9001 Certified Quality Management System

| Origination Date | Revision Date | Rev. |
|------------------|---------------|------|
| 12/10/07 | 07/14/11 | B |