

## BeO

## POWER CHIP RESISTOR

### Features:

- ◆ BeO Material
- ◆ 60 Watt Input Power
- ◆ CT = Matte Tin over Nickel over Silver
- ◆ Surface Mountable

### General Description:

The REC3725CT-50R0JN-99 is a 50 ohm surface mountable power chip resistor. It has an input power rating of 60 watts, while maintaining a constant mounting surface temperature of 100°C.

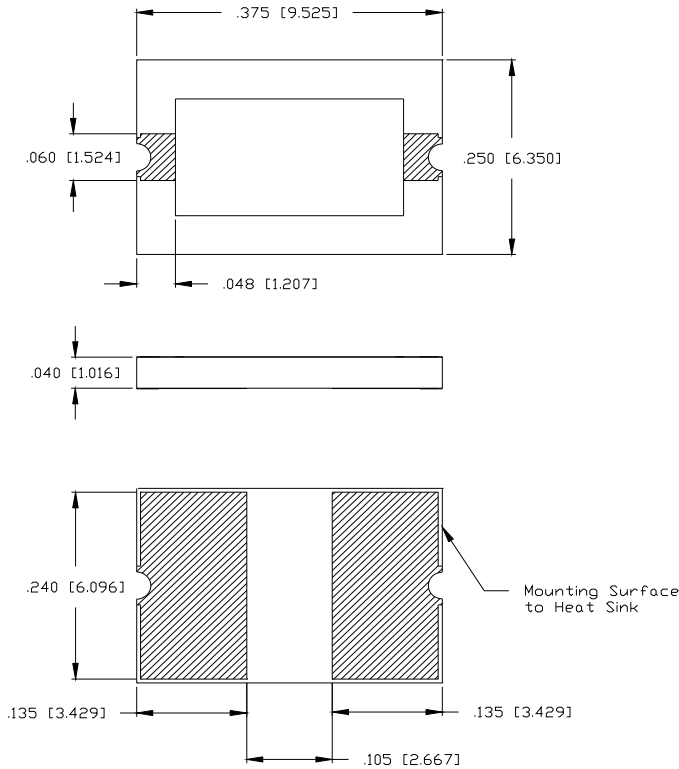

Dimensions in inches [mm]  
Tolerance  $\pm .005$  [.127]  
unless otherwise stated

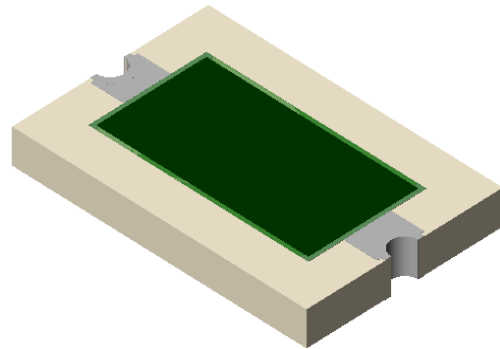

### DERATING CURVE:

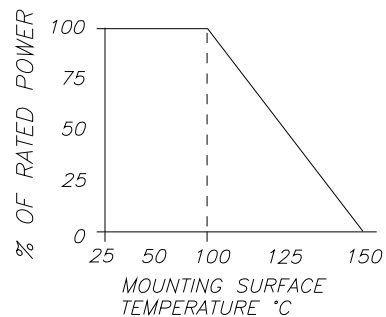

Parameter	Min.	Typ.	Max.	Units
Resistance	47.5	50	52.5	Ohms
Input Power			60	Watts
Mounting Surface Temperature			100	°C

Barry Industries reserves the right to change part number and or process without notification.

Barry Industries, Inc., 60 Walton St., Attleboro, MA 02703 T: 508-226-3350 F: 508-226-3317 E-mail: sales@barryind.com

Barry Industries maintains an ISO 9001 Certified Quality Management System

Origination Date	Revision Date	Rev.
08/02/10	08/02/10	-