

Alumina 10dB SURFACE MOUNT ATTENUATOR

Features:

- ◆ Alumina Material
- ◆ DC - 2 GHz Performance
- ◆ 15 Watt Input Power
- ◆ Surface Mountable

General Description:

The ATC2525CT-1000GN-94 is a 10 dB Alumina surface mount chip attenuator. It has an input power rating of 15 watts, while maintaining a constant mounting surface temperature of 100°C. It offers a frequency range of DC to 2 GHz.

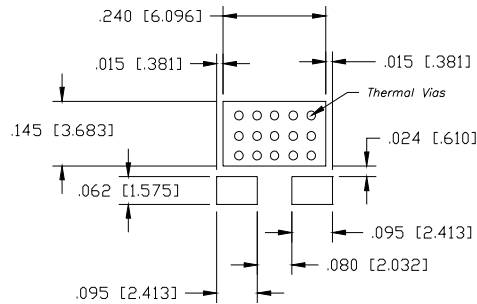
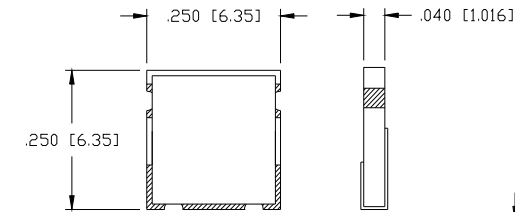

Recommended Land Pattern

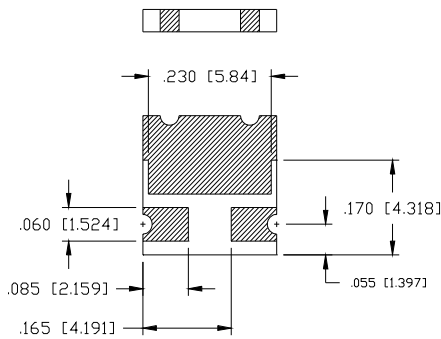
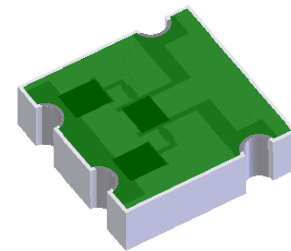

Dimensions in inches [mm]
Tolerance ± .005 [.127]
unless otherwise stated

DERATING CURVE:

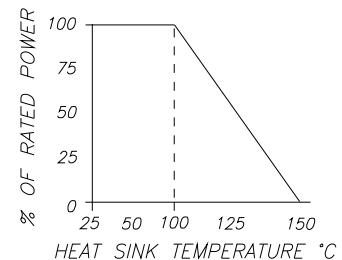

Parameter	Min.	Typ.	Max	Units
Frequency Range	DC		2	GHz
Attenuation	9	10	11	dB
Input Return Loss DC - 500 MHz	30			dB
Input Return Loss 500 - 2 GHz	19			dB
Output Return Loss DC - 500 MHz	30			dB
Output Return Loss 500 - 2 GHz	19			dB
Input Power			15	Watts
Mounting Surface Temperature			100	°C

Barry Industries reserves the right to change part number and or process without notification.