



WWW.BARRYIND.COM

# TV0805CB-XXXXJN-98

BeO

CHIP TERMINATION

### Features:

- ◆ BeO Material
- ◆ DC - 3 GHz performance
- ◆ 15 Watt Input Power
- ◆ Solder Mountable
- ◆ CB - Tin Lead over Nickel over Silver

### General Description:

The TV0805CB-XXXX\*JN-98 is a solder mountable chip termination. It has an input power of 15 watts max, while maintaining a constant mounting surface temperature of 100°C. It offers a frequency range from DC - 3 GHz.

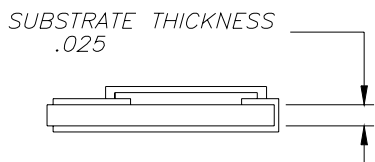
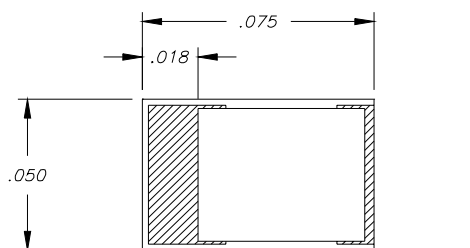

Dimensions in inches  
Tolerance ± .005  
unless otherwise stated

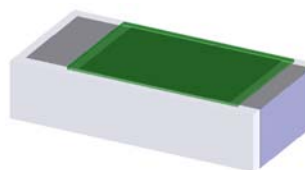

\* XXXX = Resistance Value in Ohms

- Ohms
- 0.5...R500
  - 1 .....1R00
  - 10.....10R0
  - 50.....50R0
  - 100...1000
  - 150...1500
  - 1K....1001
  - 10K...1002
  - 100K.1003
  - 470K.4703
  - 1M....1004

Sample part number:  
TV0805CB-50R0JN-98

#### DERATING CURVE:

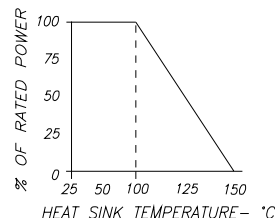

Parameter	Min.	Typ.	Max.	Units
Frequency Range	DC		3	GHz
Resistance		+/- 5%		Ohms
Input Return Loss	20			dB
Input Power			15	Watts
Mounting Surface Temperature			100	°C

Barry Industries reserves the right to change part number and or process without notification.

Barry Industries, Inc., 60 Walton St., Attleboro, MA 02703 T: 508-226-3350 F: 508-226-3317 E-mail: sales@barryind.com

Barry Industries maintains an ISO 9001 Certified Quality Management System

Origination Date	Revision Date	Rev.
10/29/03	06/30/08	B