

BeO FLANGED RESISTOR

Features:

- ◆ BeO Material
- ◆ DC - 4 GHz Performance
- ◆ 20 Watt Input Power
- ◆ Flange Mount

General Description:

The R1000-20-13X is a flanged, 100 ohm BeO resistor. It has an input power of 20 watts, while maintaining a constant flange temperature of 100°C. It offers a frequency range of DC to 4 GHz.

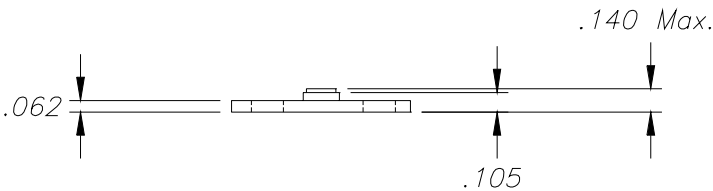
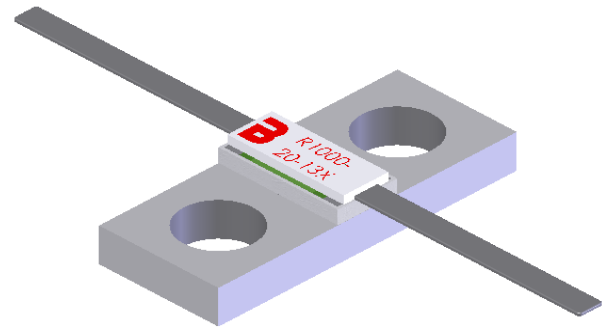
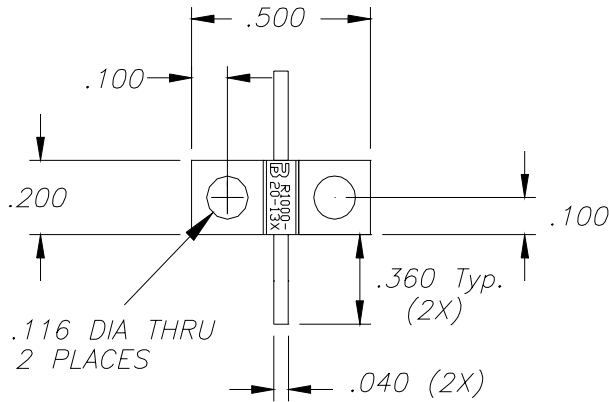

Dimensions in inches
Tolerance ± .010
unless otherwise stated

DERATING CURVE:

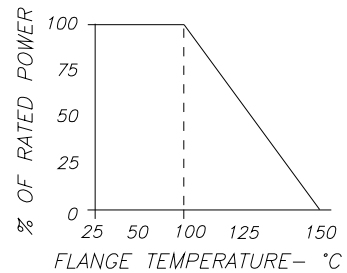

Parameter	Min.	Typ.	Max.	Units
Frequency	DC		4	GHz
Power			20	Watts
Resistance	95	100	105	Ohms
Flange Temperature			100	°C

Barry Industries reserves the right to change part number and or process without notification.

Barry Industries, Inc., 60 Walton St., Attleboro, MA 02703 T: 508-226-3350 F: 508-226-3317 E-mail: sales@barryind.com
Barry Industries maintains an ISO 9001 Certified Quality Management System

Origination Date	Revision Date	Rev.
04/02/08	04/02/08	-