



# D06Z-50R0J99-00G36-X



WWW.BARRYIND.COM

## BeO LEADED TERMINATION

### Features:

- ◆ BeO Material
- ◆ DC - 8.4 GHz Performance
- ◆ 125 Watt Input Power
- ◆ Solder Mountable

### General Description:

The D06Z-50R0J99-00G36-X is a leaded 50 ohm, BeO termination. It has an input power of 125 watts max, while maintaining a constant surface mount temperature of 100°C. It offers a frequency range from DC to 8.4 GHz.

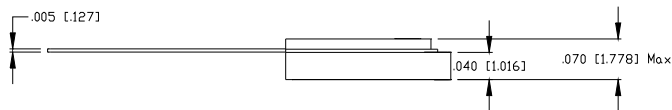
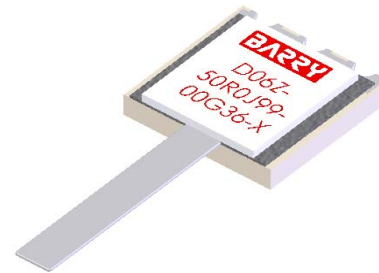
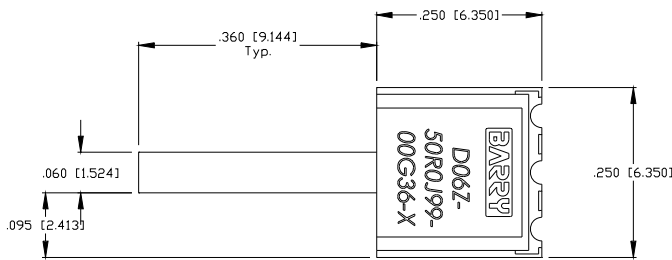

Dimensions in inches [mm]  
Tolerance  $\pm .010$  [.254]  
unless otherwise stated

DERATING CURVE:

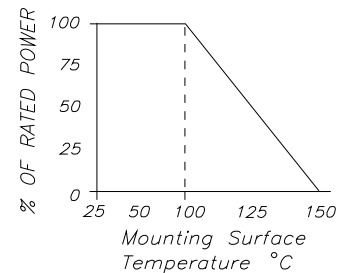

Parameter	Min.	Typ.	Max.	Units
Frequency Range	DC		8.4	GHz
Input Return Loss (DC - 6 GHz) (6 - 8.4 GHz)	20.8 12.7			dB dB
Input Power			125	Watts
Resistance	47.5	50	52.5	Ohms
Mounting Surface Temperature			100 150 (0% Power)	°C

Barry Industries reserves the right to change part number and or process without notification.

Barry Industries, Inc., 60 Walton St., Attleboro, MA 02703 T: 508-226-3350 F: 508-226-3317 E-mail: sales@barryind.com  
Barry Industries maintains an ISO 9001 Certified Quality Management System

Origination Date	Revision Date	Rev.
2/08/12	6/04/12	A