

ALUMINA

1 dB

ATTENUATOR

Features:

- ◆ .010 Alumina
- ◆ .8 Watt power dissipation
- ◆ Compact construction
- ◆ CB - Tin Lead over Nickel over Silver

General Description:

The AV0405CB-0100JN-90 is 1 dB solder mountable chip attenuator with a frequency range from DC - 4GHz and a power rating of .8 Watts while maintaining a constant heat sink temperature of 100°C Max.

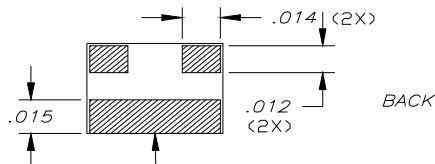
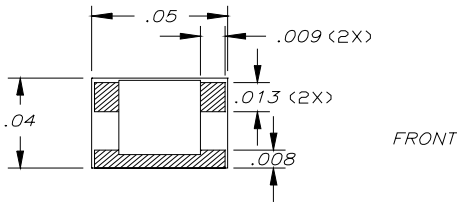

Mounting Surface to heat Sink

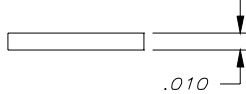

DERATING CURVE:

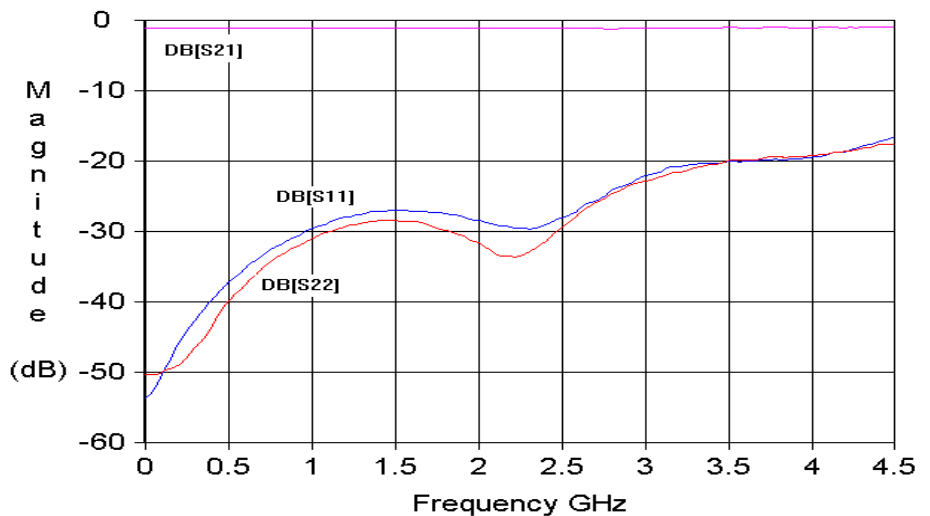
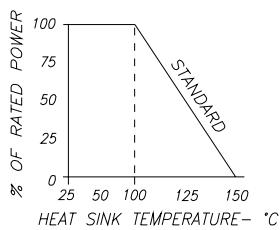

Parameter	Min.	Typ.	Max.	Units
Frequency Range	DC		4	GHz
Input Return Loss	17	26		dB
Output Return Loss	17	26		dB
Attenuation	.5	1	2	dB
Power Dissipation			.8	Watts
Heat Sink Temperature			100	°C

* Barry Industries reserves the right to change part number and or process without notification

Barry Industries, Inc., 60 Walton St., Attleboro, MA 02703 T: 508-226-3350 F: 508-226-3317 E-mail: sales@barryind.com

Barry Industries maintains an ISO 9001 Certified Quality Management System

Origination Date	Revision Date	Rev.
10/21/06	10/21/06	-