



TA50R0-800-10X



WWW.BARRYIND.COM

Aluminum Nitride

FLANGED TERMINATION

Features:

- ◆ AIN material
- ◆ 800 Watt Input Power (CW)
- ◆ DC - 1 GHz Performance

General Description:

The TA50R0-800-10X is an Aluminum Nitride flanged termination with an input power of 800 Watts (CW) while maintaining a constant 100°C flange temperature. It offers an excellent frequency range from DC to 1 GHz.

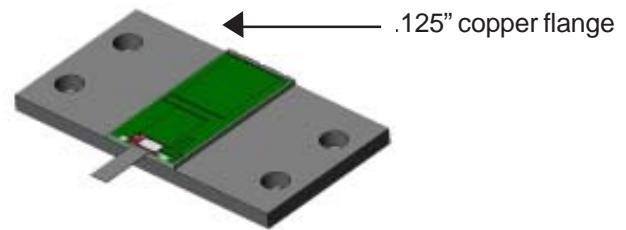
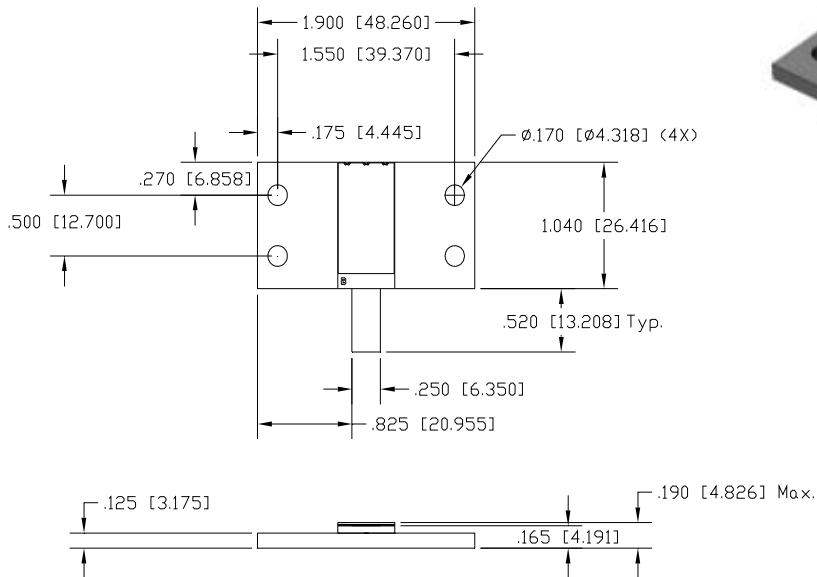

DERATING CURVE:

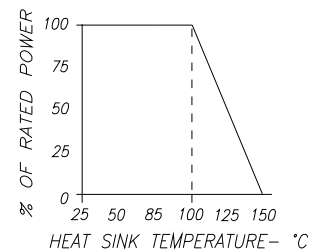

| Parameter | Min. | Typ. | Max. | Units |
|-----------------------------------|------|------|------|-------|
| Frequency Range | DC | | 1 | GHz |
| Input Return Loss DC - 860 MHz | 26 | | | dB |
| Input Return Loss 860 MHz - 1 GHz | 20 | | | dB |
| Resistance | 47.5 | 50 | 52.5 | Ohms |
| Input Power (CW) | | | 800 | Watts |
| Heat Sink Temperature | | | 100 | °C |

Barry Industries reserves the right to change part number and or process without notification.

Barry Industries, Inc., 60 Walton St., Attleboro, MA 02703 T: 508-226-3350 F: 508-226-3317 E-mail: sales@barryind.com

Barry is ISO 9001:2000 Certified by



| Origination Date | Revision Date | Rev. |
|------------------|---------------|------|
| 11/28/07 | 12/02/09 | C |