

## BeO

## FLANGED TERMINATION

### Features:

- ◆ BeO
- ◆ 350 Watt Input power
- ◆ DC - 1 GHz
- ◆ Flange mount
- ◆ 500 Watt (5 seconds)

### General Description:

The T50R0-350-1X is a 50 Ohm flanged termination capable an input power of 350 Watts while maintaining a constant flange temperature of 100°C. It offers a frequency range from DC to 1GHz.

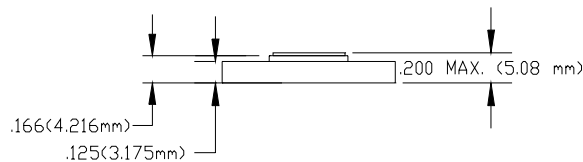
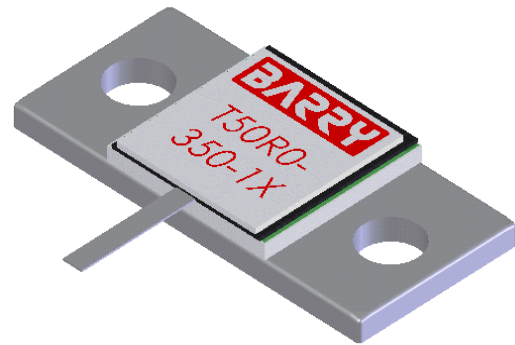
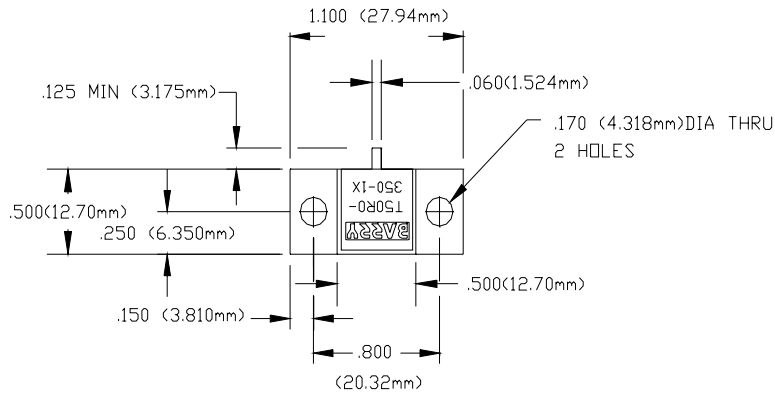

Dimensions in inches (mm)  
Tolerance  $\pm .010$  unless  
otherwise stated

### DERATING CURVE:

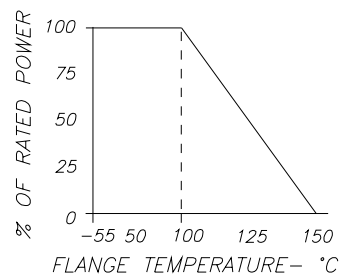

Parameter	Min.	Typ.	Max.	Units
Frequency Range	DC		1	GHz
Return Loss	26.5			dB
Input Power			350	Watts
Peak Power 5 seconds			500	Watts
Resistance	47.5	50	52.5	Ohms
Flange Temperature			100	°C

\* Barry Industries reserves the right to change part number and or process without notification

Barry Industries, Inc., 60 Walton St., Attleboro, MA 02703 T: 508-226-3350 F: 508-226-3317 E-mail: sales@barryind.com

Barry is ISO 9001:2000 Certified by



Origination Date	Revision Date	Rev.
7/26/07	8/8/07	B