



WWW.BARRYIND.COM

T50R0-250-23E



BeO

FLANGED TERMINATION

Features:

- ◆ BeO Material
- ◆ DC- 4 GHz Performance
- ◆ 250 Watt Input Power
- ◆ All Brazed Construction

General Description:

The T50R0-250-23E is a flanged 50 ohm, BeO termination. It has an input power of 250 watts at continuous RF power, at flange temperatures up to 100°C, and derated performance to 250°C. Its all brazed construction ensures that the device stays intact during assembly and offers improved cycling performance. It offers a frequency range from DC to 4 GHz.

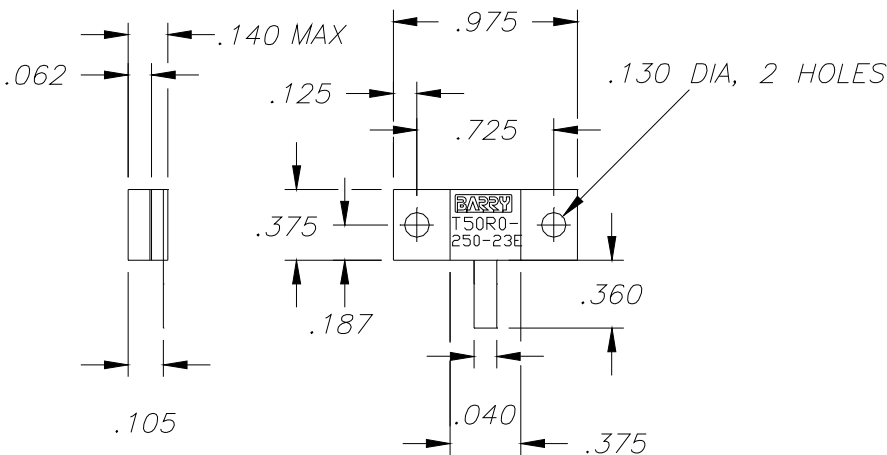

DERATING CURVE:

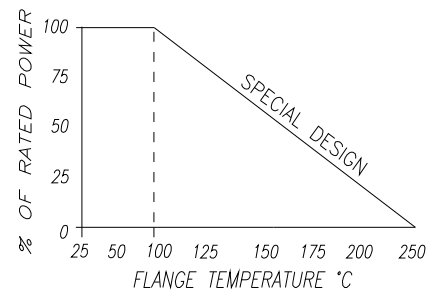

Parameter	Min.	Typ.	Max.	Units
Frequency Range	DC		4	GHz
Input Return Loss	16			dB
Input Power			250	Watts
Flange Temperature			100	°C

Barry Industries reserves the right to change part number and or process without notification.

Barry Industries, Inc., 60 Walton St., Attleboro, MA 02703 T: 508-226-3350 F: 508-226-3317 E-mail: sales@barryind.com

Barry is ISO 9001:2000 Certified by



Origination Date	Revision Date	Rev.
12/04/08	12/04/08	-