



WWW.BARRYIND.COM

T50R0-200-1E



BeO

FLANGED TERMINATION

Features:

- ◆ BeO Material
- ◆ DC- 2.0 GHz Performance
- ◆ 200 Watt Input Power
- ◆ Brazed Construction

General Description:

The T50R0-200-1E is a flange mounted BeO termination. It has an input power of 200 watts, while maintaining a constant flange temperature of 100°C. It offers a frequency from DC - 2.0 GHz. Its brazed construction ensures that the assembly stays intact during installation.

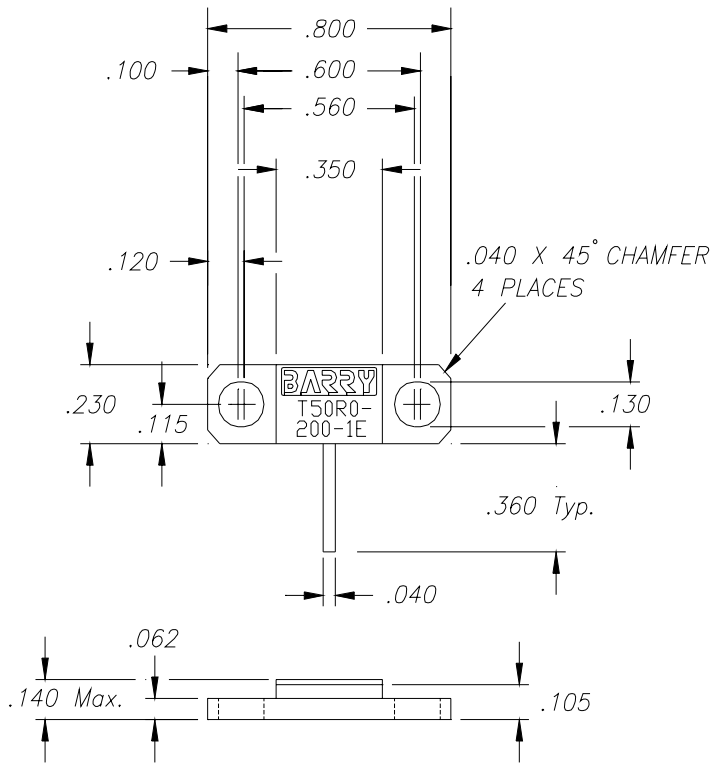

Dimensions in inches
Tolerance $\pm .010$
unless otherwise stated

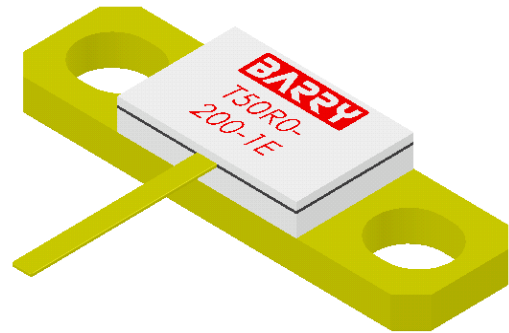

DERATING CURVE:

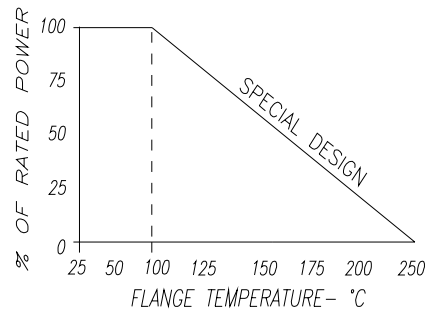

| Parameter | Min. | Typ. | Max. | Units |
|--------------------|------|------|------|-------|
| Frequency Range | DC | | 2.0 | GHz |
| Input Return Loss | 20 | | | dB |
| Input Power | | | 200 | Watts |
| Resistance | 47.5 | 50 | 52.5 | Ohms |
| Flange Temperature | | | 100 | °C |

Barry Industries reserves the right to change part number and or process without notification

Barry Industries, Inc., 60 Walton St., Attleboro, MA 02703 T: 508-226-3350 F: 508-226-3317 E-mail: sales@barryind.com

Barry Industries maintains an ISO 9001 Certified Quality Management System

| Origination Date | Revision Date | Rev. |
|------------------|---------------|------|
| 01/09/05 | 01/14/08 | B |