



WWW.BARRYIND.COM

# T50R0-125-21X



## BeO

## FLANGED TERMINATION

### Features:

- ◆ BeO Material
- ◆ DC - 6 GHz Performance
- ◆ 125 Watt Input Power
- ◆ Flange Mount

### General Description:

The T50R0-125-21X is a 50 ohm flanged BeO termination. It has an input power of 125 watts, while maintaining a constant flange temperature of 70°C. It offers an excellent frequency range of DC - 6 GHz.

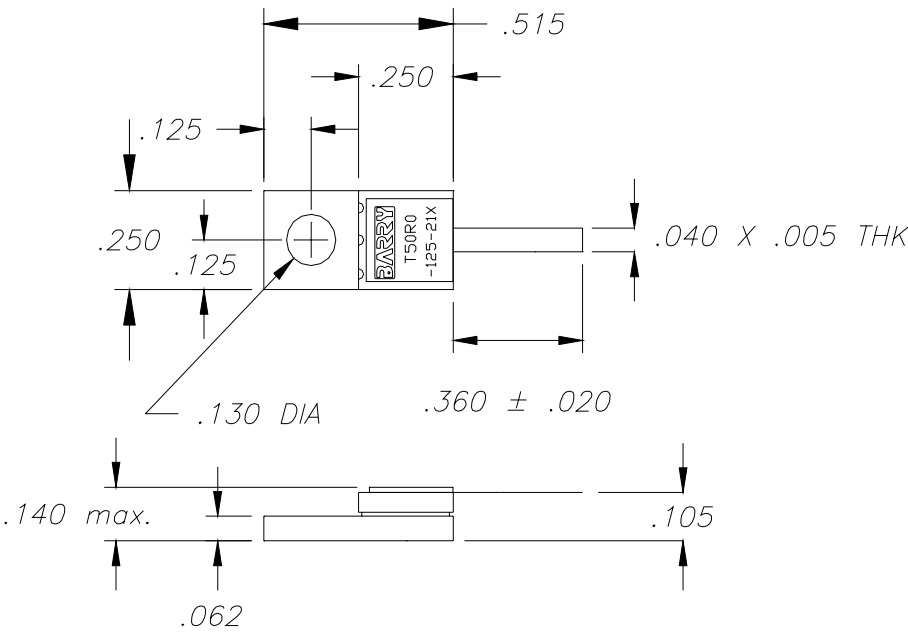

Dimensions in inches  
Tolerance ± .010  
unless otherwise noted

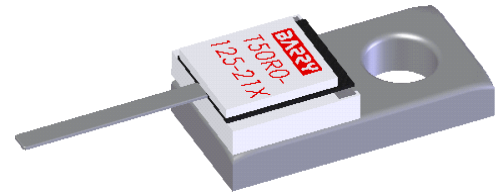

DERATING CURVE:

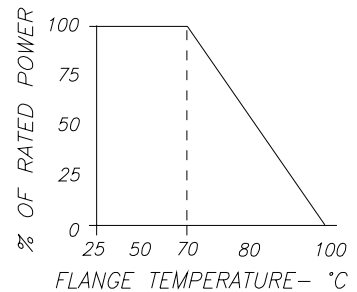

| Parameter          | Min. | Typ.   | Max. | Units |
|--------------------|------|--------|------|-------|
| Frequency Range    | DC   |        | 6    | GHz   |
| Input Return Loss  | 17   |        |      | dB    |
| Resistance         |      | +/- 5% |      | Ohms  |
| Input Power        |      |        | 125  | Watts |
| Flange Temperature |      |        | 70   | °C    |

Barry Industries reserves the right to change part number and or process without notification

Barry Industries, Inc., 60 Walton St., Attleboro, MA 02703 T: 508-226-3350 F: 508-226-3317 E-mail: sales@barryind.com

Barry Industries maintains an ISO 9001 Certified Quality Management System

| Origination Date | Revision Date | Rev. |
|------------------|---------------|------|
| 11/26/07         | 11/26/07      | -    |