



WWW.BARRYIND.COM

# RXXXX-50-2E



## BeO

## FLANGED RESISTOR

### Features:

- ◆ BeO Material
- ◆ 50 Watt Input Power
- ◆ Flange Mount

### General Description:

The RXXXX\*-50-2E is a flanged BeO resistor. It has an input power of 50 watts max, while maintaining a flange temperature of 100°C. It offers standard resistance values of 50 and 100 ohms. Other values available, please contact the factory for ordering.

\*Example part numbers: R1000-50-2E = 100 ohms  
R50R0-50-2E = 50 ohms

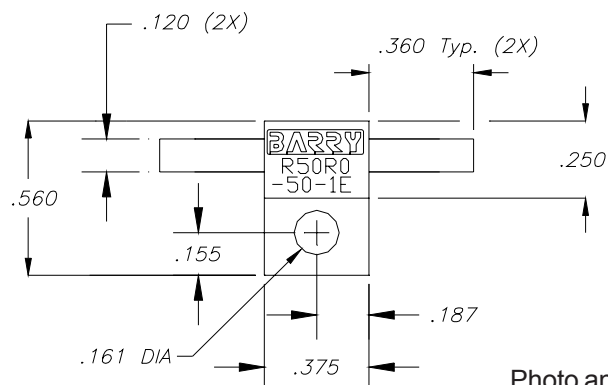
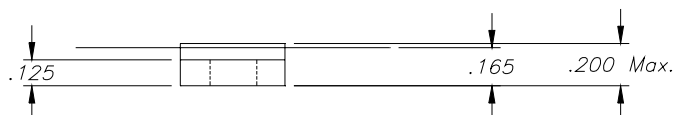
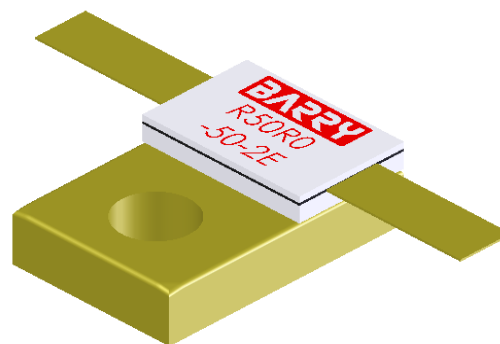
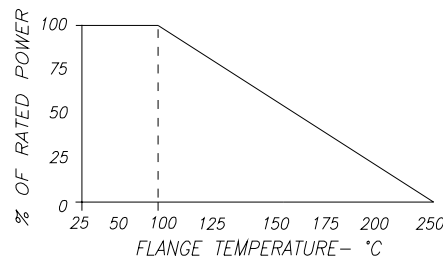

Photo and drawing show a 50 ohm device. 100 ohm device would show RA1000-50-1X.



Dimensions in inches  
Tolerance ± .010  
unless otherwise stated

### DERATING CURVE:



Parameter	Min.	Typ.	Max.	Units
Input Power			50	Watts
Resistance		+/- 5%		Ohms
Flange Temperature			100	°C

Barry Industries reserves the right to change part number and or process without notification

Barry Industries, Inc., 60 Walton St., Attleboro, MA 02703 T: 508-226-3350 F: 508-226-3317 E-mail: sales@barryind.com  
Barry Industries maintains an ISO 9001 Certified Quality Management System

Origination Date	Revision Date	Rev.
04/07/05	02/12/08	B