



WWW.BARRYIND.COM

# R50R0-150-15E



**BeO**

## FLANGED RESISTOR

### Features:

- ◆ BeO Material
- ◆ 150 Watt Input Power
- ◆ All Brazed Construction
- ◆ Flange Mount

### General Description:

The R50R0-150-15E is a flanged 50 ohm, BeO resistor. It has an input power of 150 watts at continuous RF power, at flange temperatures up to 100°C, and derated performance to 250°C. Its all brazed construction ensures that the device stays intact during assembly and offers improved cycling performance.

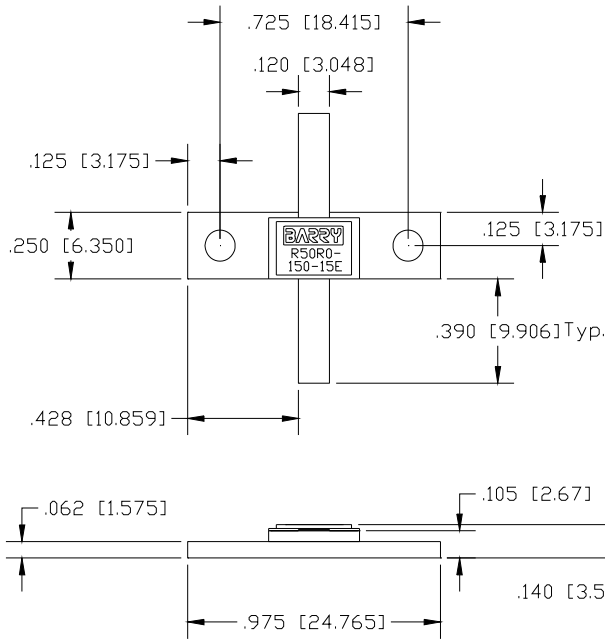

Dimensions in inches [mm]  
Tolerance ± .010 [.254]  
unless otherwise stated

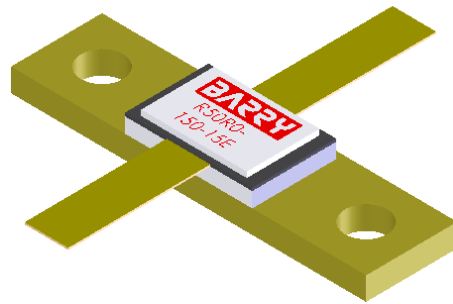

DERATING CURVE:

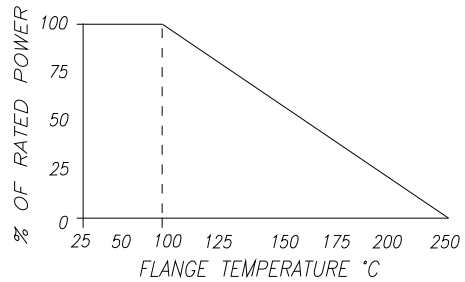

Parameter	Min.	Typ.	Max.	Units
Input Power			150	Watts
Resistance	47.5	50	52.5	
Flange Temperature			100	°C

Barry Industries reserves the right to change part number and or process without notification.

Barry Industries, Inc., 60 Walton St., Attleboro, MA 02703 T: 508-226-3350 F: 508-226-3317 E-mail: sales@barryind.com  
Barry Industries maintains an ISO 9001 Certified Quality Management System

Origination Date	Revision Date	Rev.
12/23/08	12/23/08	-