



WWW.BARRYIND.COM

# R1000-400-2X



## BeO

## FLANGED RESISTOR

### Features:

- ◆ BeO Material
- ◆ 400 Watt Input Power

### General Description:

The R1000-400-2X is a flanged 100 ohm, BeO resistor. It has an input power of 400 watts, while maintaining a constant flange temperature of 100°C.

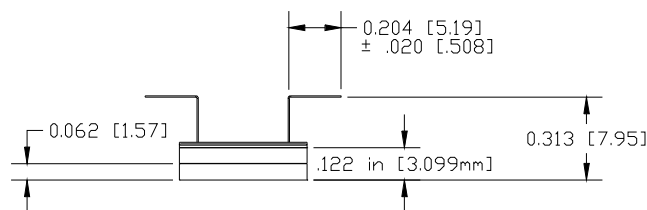
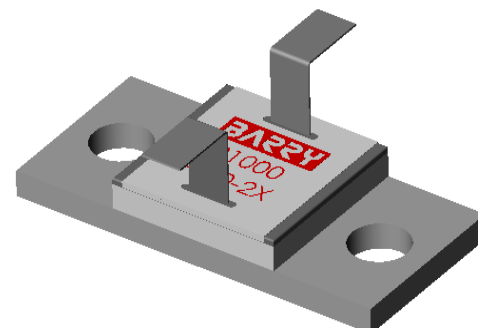
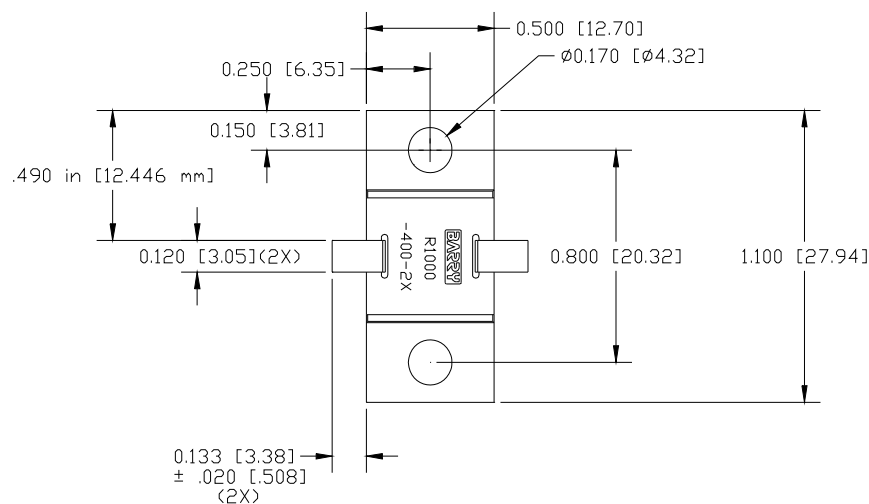

Dimensions in inches [mm]  
Tolerance  $\pm .010$  [.254mm]  
unless otherwise stated

### DERATING CURVE:

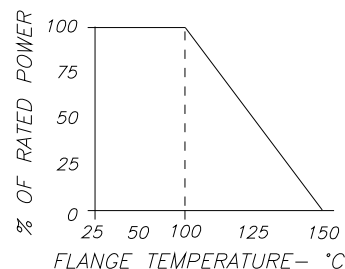

Parameter	Min.	Typ.	Max.	Units
Input Power			400	Watts
Impedance	95	100	105	
Dielectric Withstanding Voltage (per MIL Standard 202, Method 301)			5.0	kV
Capacitance		5.2		pF
Flange Temperature			100	°C

Barry Industries reserves the right to change part number and or process without notification.

Barry Industries, Inc., 60 Walton St., Attleboro, MA 02703 T: 508-226-3350 F: 508-226-3317 E-mail: sales@barryind.com

Barry is ISO 9001:2000 Certified by



Origination Date	Revision Date	Rev.
10/23/08	10/23/08	-