



TA50R0-800-15X



WWW.BARRYIND.COM

Aluminum Nitride

FLANGED TERMINATION

Features:

- ◆ AIN Material
- ◆ 800 Watt Input Power (CW)
- ◆ DC - 1 GHz Performance

General Description:

The TA50R0-800-15X is an Aluminum Nitride 50 ohm flanged termination with an input power of 800 Watts (CW) while maintaining a constant 100°C flange temperature. It offers an excellent frequency range from DC to 1 GHz.

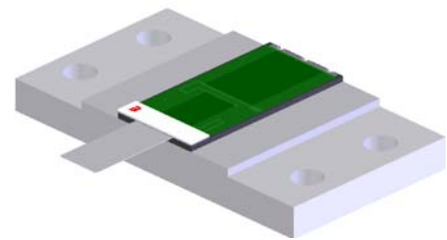
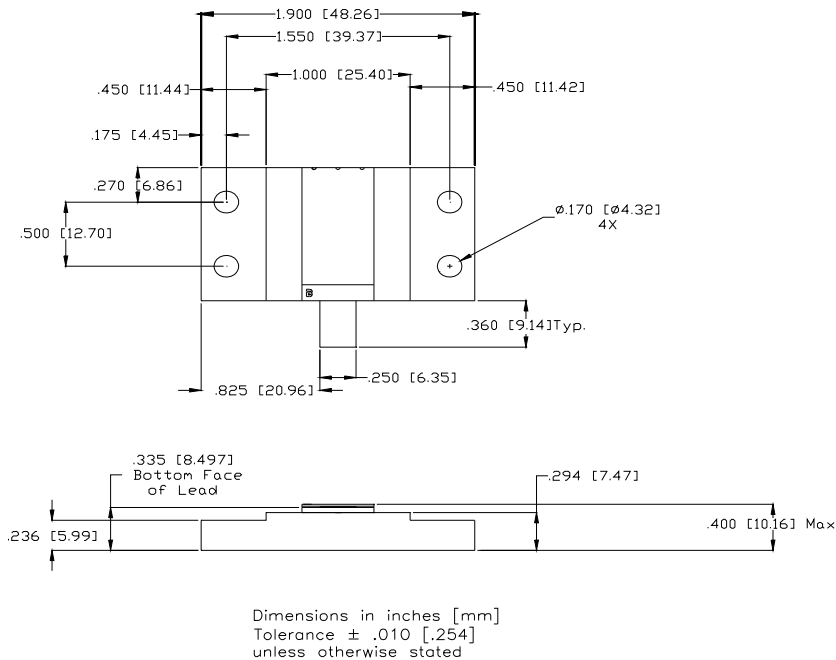

DERATING CURVE:

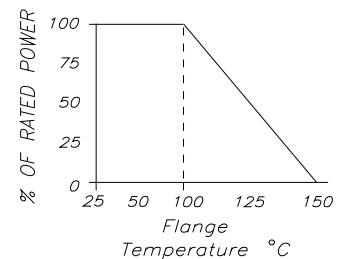

Parameter	Min.	Typ.	Max.	Units
Frequency Range	DC		1	GHz
Input Return Loss DC - 860 MHz	30.7			dB
Input Return Loss >860 MHz - 1 GHz	20.0			dB
Resistance	47.5	50	52.5	Ohms
Input Power (CW)			800	Watts
Flange Temperature			100 150 (0% Power)	°C

Barry Industries reserves the right to change part number and or process without notification

Barry Industries, Inc., 60 Walton St., Attleboro, MA 02703 T: 508-226-3350 F: 508-226-3317 E-mail: sales@barryind.com
Barry Industries, Inc. maintains an ISO 9001 Certified Quality Management System

Origination Date	Revision Date	Rev.
06/19/12	06/19/12	-