



WWW.BARRYIND.COM

# RZC2010CT-50R0JN-2S-03



## Aluminum Nitride

## POWER CHIP TERMINATION

### Features:

- ◆ Aluminum Nitride Material
- ◆ DC - 5 GHz Performance
- ◆ Surface Mount
- ◆ 30 Watt Input Power
- ◆ Surface Mountable

### General Description:

The RZC2010CT-50R0JN-2S-03 is a 50 ohm standard surface mountable power chip termination. It has an input rating of 30 watts, while maintaining a constant heat sink temperature of 100°C. It offers an excellent frequency range from DC to 5 GHz.



Front

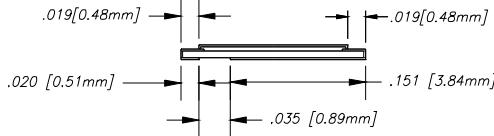
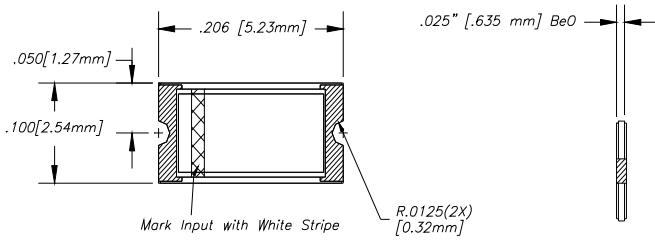

Dimension Tolerance +/- .005" (.127mm)

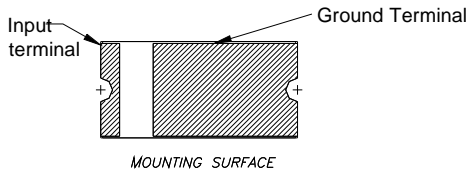

Recommended Land Pattern

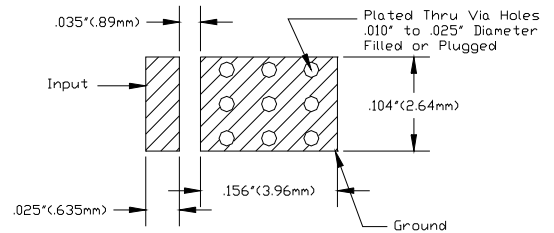

DERATING CURVE:

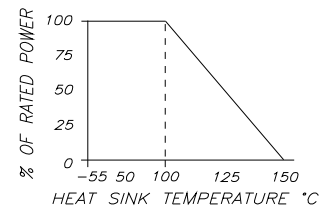

Parameter	Min.	Typ.	Max.	Units
Frequency Range	DC		5	GHz
Input Return Loss	20 (1.22:1)	36 (1.03:1)		dB (VSWR)
DC Resistance	47.5	50	52.5	Ohms
Input Power			30	Watts
Heat Sink Temperature			100	°C

Barry Industries reserves the right to change part number and or process without notification.

Barry Industries, Inc., 60 Walton St., Attleboro, MA 02703 T: 508-226-3350 F: 508-226-3317 E-mail: sales@barryind.com

Barry Industries maintains an ISO 9001 Certified Quality Management System

Origination Date	Revision Date	Rev.
05/19/09	05/19/09	-