



WWW.BARRYIND.COM

TV0402CB-1000GN-96-01

BeO

CHIP TERMINATION

Features:

- ◆ BeO Material
- ◆ DC - 20 GHz Performance
- ◆ 2.5 Watt Input Power
- ◆ Solder Mountable
- ◆ CB - Tin Lead over Nickel over Silver

General Description:

The TV0402CB-1000GN-96-01 is a solder mountable 100 ohm chip termination. It has an input power of 2.5 watts, while maintaining a constant mounting surface temperature of 70°C. It offers a frequency range from DC to 20 GHz.

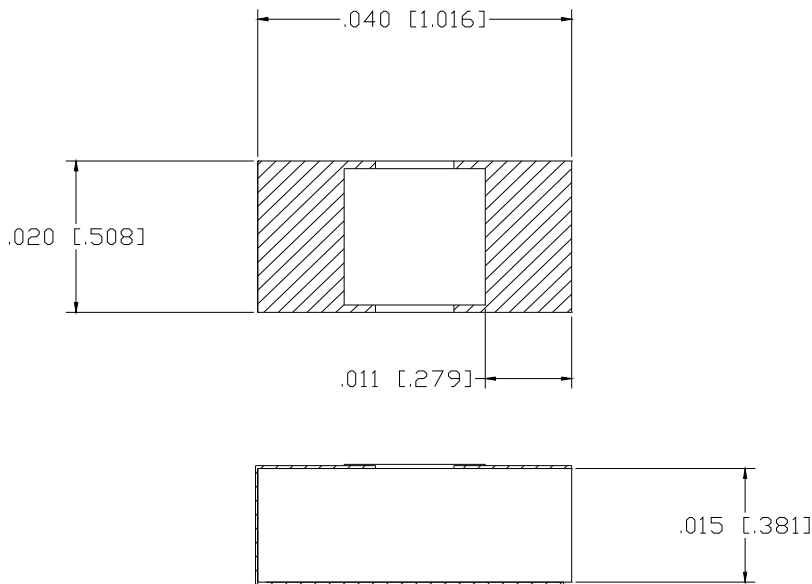

Dimensions in inches [mm]
Tolerance $\pm .003$ [.076]
unless otherwise stated

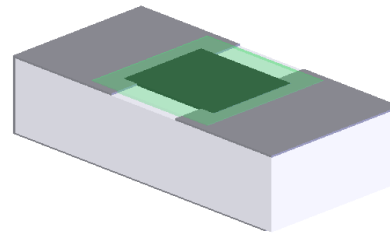

DERATING CURVE:

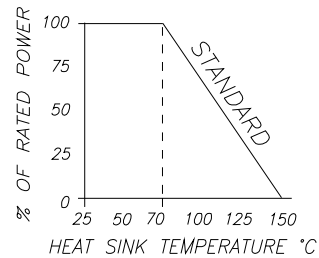

Parameter	Min.	Typ.	Max.	Units
Frequency Range	DC		20	GHz
Resistance	98	100	102	Ohms
Input Return Loss	17			dB
Input Power			2.5	Watts
Mounting Surface Temperature			70	°C

Barry Industries reserves the right to change part number and or process without notification.

Barry Industries, Inc., 60 Walton St., Attleboro, MA 02703 T: 508-226-3350 F: 508-226-3317 E-mail: sales@barryind.com

Barry Industries maintains an ISO 9001 Certified Quality Management System

Origination Date	Revision Date	Rev.
07/06/09	07/06/09	-