



# RXXXX\*-250-1X



WWW.BARRYIND.COM

BeO

## FLANGED RESISTOR

### Features:

- ◆ BeO Material
- ◆ 250 Watts
- ◆ Flange Mount

### General Description:

The RXXXX\*-250-1X is a flanged Beo resistor. It has an input power rating of 250 watts, while maintaining a constant flange temperature of 100°C. \*Standard values are 50 ohms and 100 ohms. Please consult the factory for specific resistance values. (Special ohmic value requests welcome.)

Example part numbers: R50R0-250-1X = 50 Ohms  
R1000-250-1X = 100 Ohms

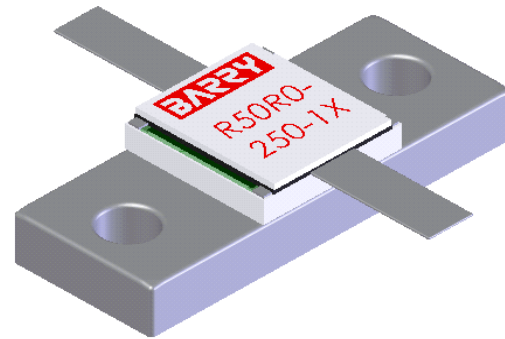
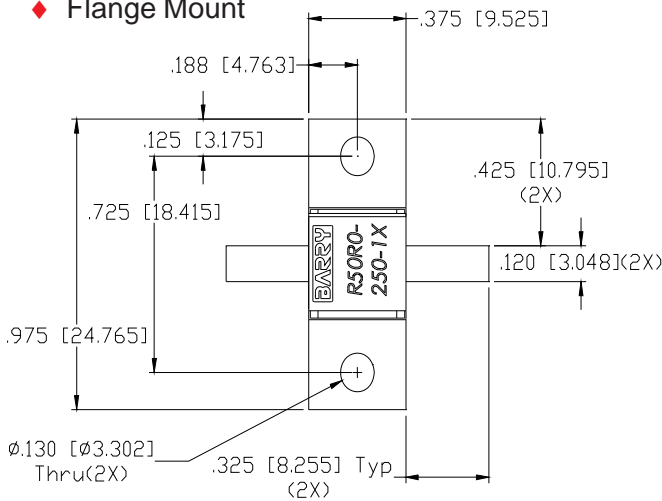

Illustrations depict 50 ohm device.

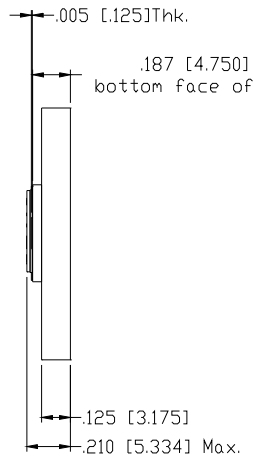

Dimensions in inches [mm]  
Tolerance ± .010 [.254]  
unless otherwise stated

DERATING CURVE:

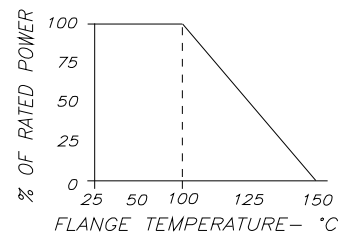

Parameter	Min.	Typ.	Max.	Units
Input Power			250	Watts
Resistance Tolerance		+/- 5%		Ohms
Temperature Coefficient of Resistance	-200		+200	PPM/°C
Flange Temperature			100	°C

Barry Industries reserves the right to change part number and or process without notification.

Barry Industries, Inc., 60 Walton St., Attleboro, MA 02703 T: 508-226-3350 F: 508-226-3317 E-mail: sales@barryind.com

Barry Industries maintains an ISO 9001 Certified Quality Management System

Origination Date	Revision Date	Rev.
11/29/07	01/19/11	B