



WWW.BARRYIND.COM

R1000-400-1X



BeO

RESISTOR

Features:

- ◆ BeO material
- ◆ Flange mounted
- ◆ 400 Watt Input power

General Description:

The R1000-400-1X is a 100 Ohm BeO flange mounted resistor capable of an input power of 400 Watts while maintaining a constant flange temperature of 100°C max.

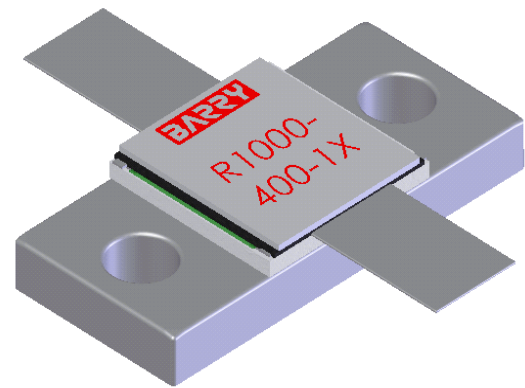
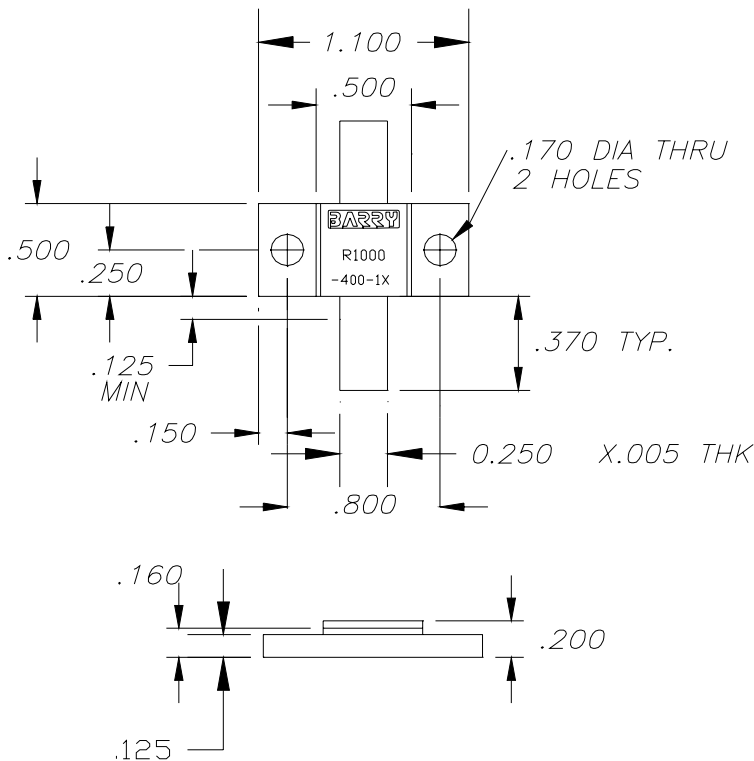

DERATING CURVE:

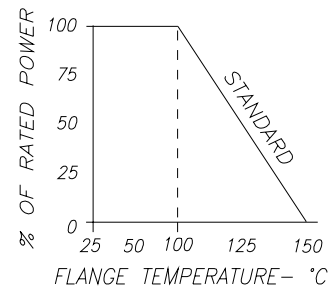

Parameter	Min.	Typ.	Max.	Units
Input Power			400	Watts
Resistance	95	100	105	Ohm
Flange Temperature			100	°C

* Barry Industries reserves the right to change part number and or process without notification

Barry Industries, Inc., 60 Walton St., Attleboro, MA 02703 T: 508-226-3350 F: 508-226-3317 E-mail: sales@barryind.com

Barry Industries maintains an ISO 9001 Certified Quality Management System

Origination Date	Revision Date	Rev.
03/26/07	03/26/07	-